

Check Valves

(Ball Type & Wafer Type)

Automat's high-performance check valves designed for optimal flow control and backflow prevention in various applications. Available in two distinct types—Wafer Type Check Valve and Ball Check Valve—each valve offers unique features to meet your specific needs.



HIGHLIGHTS

Ball Check Valve

- **Low Sealing Pressure:** Ensures efficient operation while minimizing energy use.
- **Universal Flange Connections:** Compatible with a wide range of systems for easy integration.
- **Spring Loaded Mechanism:** Guided internal movement provides smooth operation, enhancing reliability.
- **Pre-Installed Vacuum Breaker:** Prevents potential issues by maintaining system integrity.
- **Pump Priming Option:** Inlet pressure port facilitates easy pump priming, optimizing performance.

HIGHLIGHTS

Wafer Type Check Valve

- **Easy Installation:** Slips seamlessly between standard flanges for quick setup.
- **No Gaskets Required:** Simplifies the installation process, reducing time and costs.
- **Durable Material:** Constructed from excellent chemical and corrosion-resistant U-PVC material, ensuring longevity.
- **Lightweight Design:** Requires less space, making it ideal for various installations.
- **Installation Markings:** Clear markings ensure correct installation every time.



Technical Data – Ball Type Check Valves

Model No		96-SL/PT	97-SL/PT	98-SL/PT	96-EP/ET/EF	97-EP/ET/EF	98-EP/ET/EF
Inlet Connection		2" (50 mm)	2.5" (65 mm)	3" (80 mm)	2" (50 mm)	2.5" (65 mm)	3" (80 mm)
Maximum Working Pressure	BAR	6			4		
	PSI	85			58		
Connection	Type	Flanged (SL) / Threaded (PT)			Glued (EP) / Female Threaded (BSP/NPT) (ET) / Flanged (EF)		
	Standard	Universal			Glued (ISO and ASTM), Universal		
Sealing Pressure	BAR				0.2		
	PSI				3		
Material of Constructions		PPGF			PP		

Product Dimensions

Dimensions		96-SL/EF	97-SL/EF	98-SL/EF
A	CM	16.1	19	20.6
	INCH	6 11/32	7 31/64	8 7/64
B	CM	17.1	23.2	23.8
	INCH	6 47/64	9 9/64	9 3/8
C	CM	1.90	2.2	2.4
	INCH	3/4	55/64	15/16

Dimensions		96-PT/EP/ET	97-PT/EP/ET	98-PT/EP/ET
A	CM	15.3	18.5	19.9
	INCH	6 1/32	7 7/32	7 53/64
B	CM	19.8	27.1	27.4
	INCH	7 51/64	10 43/64	10 25/32
C	CM	7.4	9.2	10.8
	INCH	2 27/32	3 5/8	4 1/4

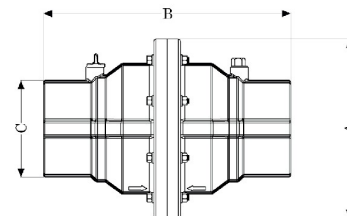
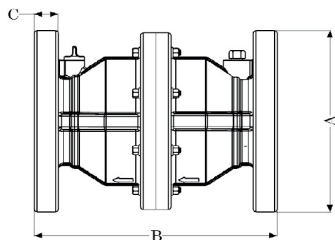

Head Loss Chart

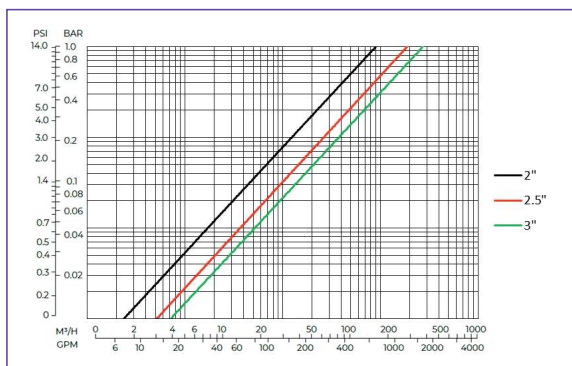

Technical Data – Wafer Type Check Valves

Model No		AQ-298	AQ-299
Inlet /Outlet Connection		3" (80 mm)	4" (100 mm)
Connection		Wafer Type	
Cracking Pressure	BAR	0.2	
	PSI	3	
Maximum Working Pressure	BAR	6	
	PSI	85	



Product Dimensions

Dimensions		AQ-298	AQ-299
A	CM	5.7	7.7
	INCH	2 ¼	3 ½ ₃₂
B	CM	12.9	15.9
	INCH	5 5 ₆₄	6 17 ₆₄
C	CM	2.1	2.5
	INCH	53 ₆₄	63 ₆₄
D	CM	6.2	6.6
	INCH	2 7 ₁₆	2 19 ₃₂

Material Specification

Part No	Description	Material
1	Body	PVC
2	Flap (Swing)	PVC
3	Lock Button	PPGF
4	Body O-Ring	EPDM
5	Flap O-Ring	EPDM
6	I-Bolt	M.ST.

